

- The cutting points of the horizontal and vertical pipes from the SDM pipe with a wall thickness of diameter of 114 mm are connected to each other with doetail metal clamps with a minimum 3 mm to form a right angle.
- The open parts of the Ø 114 mm diameter SDM pipes are detailed to prevent rusting caused by water and moisture, shaped with hemispherical injection molds, sealed with self-colored plastic plugs and riveted.
- Pull-up climbing step section is formed by using Ø 32 mm pipes between 4 pcs side pillars height of minimum 2,3 m Ø 114 mm pipes.
- A pull-up climbing figure made of 8 pieces of self-colored polyethylene plastic material LLDPE (Linear Low Density Polyethylene) is used in this pull-up climbing.
- These pull-up climbing figures are mounted by attaching them to the upper pipes with a diameter of Ø 32 mm.
- After the clamp connection is made, there are no protrusions or sharp corners that may cause injury anywhere.
- The parts are painted by baking with polyester-based electrostatic powder coating

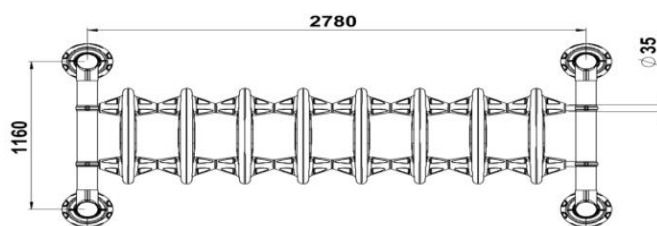
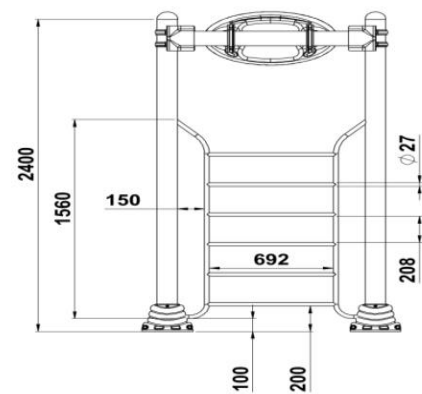
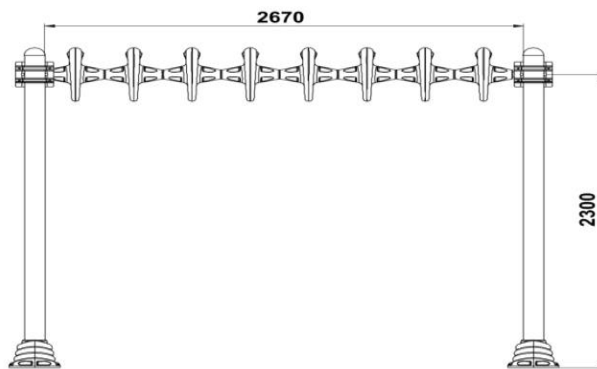

Dimensions	Side Pipe Length	230 cm
	Intermediate Deceleration Length	278 cm
	Side Climbing Pipe Thickness	32 mm