

PD-02

Oblique Barbell

- The main carrier pipes are manufactured from SDM pipes with a wall thickness of at least $\text{Ø } 139$ mm and 2.5-3 mm.
- The anchor covers, which are $\text{Ø}139$ mm in size in accordance with the design so that they fully grasp the carrier pipes, are used to close the open-ended pipes in fitness products.
- Anchor covers are manufactured from polyethylene plastic material by LLDPE (Linear Low Density Polyethylene) injection method.
- It is designed to be resistant to UV lights and not to harm the user.
- The unit is manufactured as a double wall and its installation is provided with a screwing system.
- $\text{Ø } 27$ mm twisted pipes are mounted on the carrier pipe with inclined screw technique.
- In accordance with the product function, it is designed in such a way that a person can use it alone.
- The $\text{Ø } 35$ pipe or mounted weights are produced as fixed in such a way that they cannot be changed by the user.
- Weightlifting equipment is designed to ensure that the arm and abdominal muscles of the body work in a coordinated manner.
- Damping wedge is used to prevent finger pinching.
- The main body flashes are laser cut from ST37 sheet metal with a thickness of 8 mm and a size of 280x280 mm.

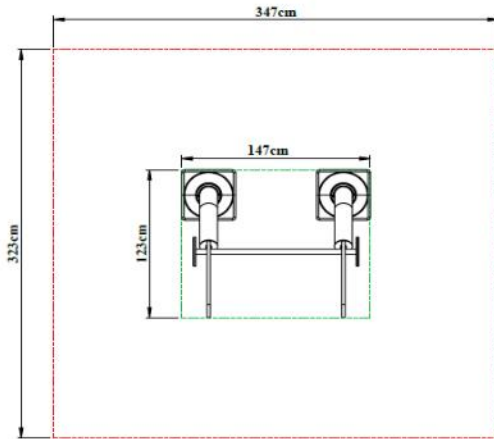
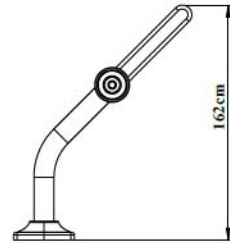
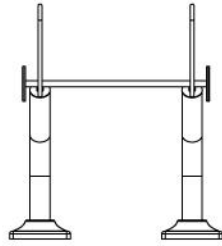

Dimensions	Width	123 cm
	Length	147 cm
	Height	162 cm