

PY-75

Swing Seat

- The seat is designed to hug the user's body and is made of self-colored polyethylene plastic material LLDPE (Linear Low Density Polyethylene) weighing at least 2,5 kg.
- The distance between the bottom of the polyethylene swivel seat and the floor should not be less than 40 cm.

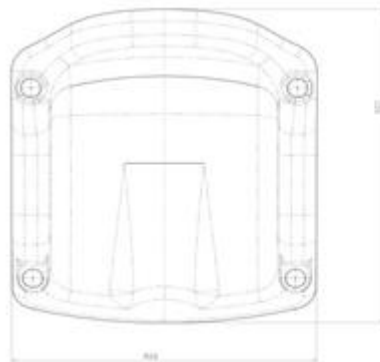
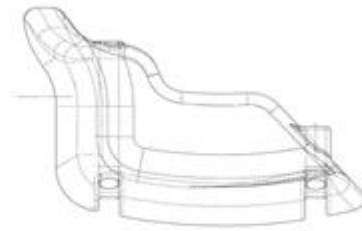
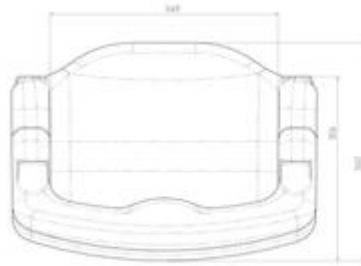

Dimensions	Swing Seat Width	44 cm
	Swing Seat Length	32 cm
	Swing Seat Height	33 cm
Features	Minimum Swing Seat Weight	2,5 kg
	Raw materials	LLDPE