

PY-86

60 Cm Tube

- The 60 cm tubes forming the tube slides are manufactured as a single piece from self-colored polyethylene plastic material, LLDPE (Linear Low Density Polyethylene) rotation molding method.
- Installation of the product is provided by screwing method.
- In order for the product surface to be smooth; Sandblasting is applied to the surface of the mold made of aluminum or its equivalent material, and it is produced by passing the Teflon coating process for surface brightness.

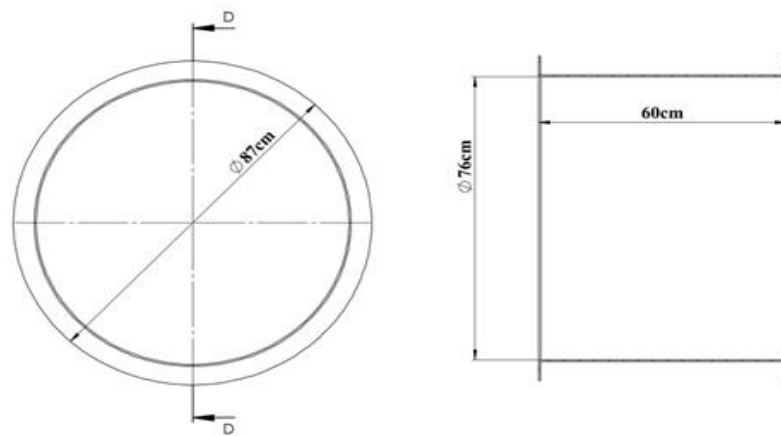

Dimensions	Tube Length	60 cm
	Tube Diameter	87 cm
Features	Minimum Weight	14 kg
	Raw materials	LLDPE